

## Summary

**Parcel Number** 11273025  
**Location Address** 1721 HILL RISE DR  
 LEXINGTON KY 40504  
**Tax District** District 01  
**Tax Rate** 1.2638  
**Acres** 0.213  
**Legal Description** LOT 1  
**Property Class** M - MULTI-FAMILY  
**PVA Neighborhood** 717 - VERSAILLES  
**Land Use Code** (401) M - APARTMENTS 3-19 RENTAL UNITS  
**USA/RSA Map** 31  
**Map Block** 001  
**Lot** 1  
**Subdivision**  
**Cabinet/Slide**  
**ND-1 Zone**  
**Overlay**  
**PDR**  
**Map Scale** 200  
**Block** A  
**Council District** 11  
**LFUCG Zoning** R-3 - PLANNED NBHD RESIDENTIAL  
**Deeded SqFt** 9278  
**Frontage / Out of** 112 /



97cd9090-9709-4087-9aa9-650a3220eb90

## Owner

[BLUEGRASS COUNTRY PROPERTIES LLC](#)  
 PO BOX 54517  
 LEXINGTON KY 40555 4517  
**January 1, 2026 Owner**  
 BLUEGRASS COUNTRY PROPERTIES LLC

## Commercial Improvement Information

<b>Card</b>	1	<b>Year Built</b>	1977
<b>Building No</b>	1	<b>Above Grade Sqft</b>	5,481
<b>Structure Code/Desc</b>	211-APARTMENTS	<b>Total Basement Sqft</b>	1131
<b>Units</b>	6		

## Sales

Sale Date	Sale Price	Deed Book	Deed Page	Sales Validity	Owner	Previous Owner	Recording
8/15/2003	\$0	2390	134	TRANSFER-TAX NOT PAID	BLUEGRASS COUNTRY PROPERTIES LLC	LEHMAN WILLIAM J	2390 134
7/9/1997	\$180,000	1922	489	ARMS LENGTH TRANSACTION	LEHMAN WILLIAM J	ISAACS DON W INC	1922 489
10/21/1986	\$4,200	0946	504		STUMBO WM L & LORETTA P	TERRACE VIEW INC	0946 504
7/15/1976	\$10,000	1149	816	ARMS LENGTH TRANSACTION	ISAACS DON W INC	COMPTON CARL D & R	1149 816
2/24/1970	\$4,300	0982	191		COMPTON CARL D & ROSEMARY	STUMBO WM L & LORETTA P	0982 191

## Valuation

	2026	2025	2024	2023
Fair Cash Value	\$325,100	\$325,100	\$200,000	\$200,000
Agricultural Value Land	\$0	\$0	\$0	\$0
Agricultural Value Total	\$0	\$0	\$0	\$0
Exempt	\$0	\$0	\$0	\$0
Taxable Value	\$325,100	\$325,100	\$200,000	\$200,000

## Sketches

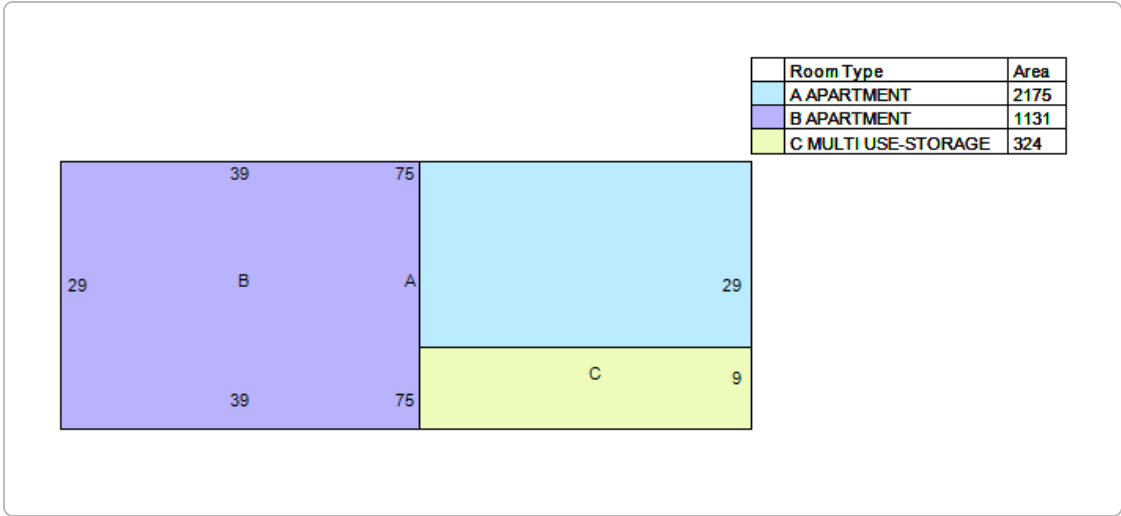

**Photos**



No data available for the following modules: Assessment Notice, Residential Improvement Information, Accessory Information, Comparable Sales List, .

The Fayette County Property Valuation Administrator's Office makes every effort to produce the most accurate information possible. No warranties, expressed or implied, are provided for the data herein, its use or interpretation.  
 | [User Privacy Policy](#) | [GDPR Privacy Notice](#)  
 Last Data Upload: 6/16/2026, 11:10:00 AM

Contact Us

