

Summary

Parcel Number 15029380
Location Address 1048 EASTLAND DR
 LEXINGTON KY 40505
Tax District District 01
Tax Rate 1.2643
Acres 0.34
Legal Description K-189 LOT
Property Class C - COMMERCIAL
PVA Neighborhood 721 - WINCHESTER
Land Use Code (410) C-INDUSTRIAL
USA/RSA Map 26
Map Block 034
Lot 13
Subdivision PICKLESIMER UNIT-1
Cabinet/Slide K-189
ND-1 Zone
Overlay
PDR
Map Scale 200
Block B
LFUCG Zoning I-1 - LIGHT INDUSTRIAL
Deeded SqFt 14,810
Frontage / Out of 48.4 / PCLS 10&11



Owner

[EASTLAND DRIVE INDUSTRIAL LLC](#)
 3509 CAICOS CT
 LEXINGTON KY 40509
January 1, 2024 Owner
 EASTLAND DRIVE INDUSTRIAL LLC

Commercial Improvement Information

Card	1	Year Built	1974
Building No	1	Above Grade Sqft	6,935
Structure Code/Desc	398-WAREHOUSE	Total Basement Sqft	
Units	1		

Accessory Information

Card 1

Description	Year Built	Size	Area	Grade
PAVING ASPHALT PARKING	1970		3,000	C -AVERAGE

Sales

Sale Date	Sale Price	Deed Book	Deed Page	Sales Validity	Owner	Previous Owner	Recording
4/8/2022	\$1,800,000	3930	103	MULTIPLE PROPERTIES	EASTLAND DRIVE INDUSTRIAL LLC	MCB ENTERPRISES LLC	3930 103
4/6/2001	\$136,500	2196	716	MULTIPLE PROPERTIES	MCB ENTERPRISES LLC	PICKLESIMER F M DR & JD	2196 716
1/2/1971	\$0	1009	071	ARMS LENGTH TRANSACTION	PICKLESIMER F M DR & JD	PICKLESIMER F M JR	1009 071

Valuation

	2023	2022	2021	2020
Fair Cash Value	\$420,000	\$426,400	\$173,400	\$173,400
Agricultural Value Land	\$0	\$0	\$0	\$0
Agricultural Value Total	\$0	\$0	\$0	\$0
Exempt	\$0	\$0	\$0	\$0
Taxable Value	\$420,000	\$426,400	\$173,400	\$173,400

Sketches

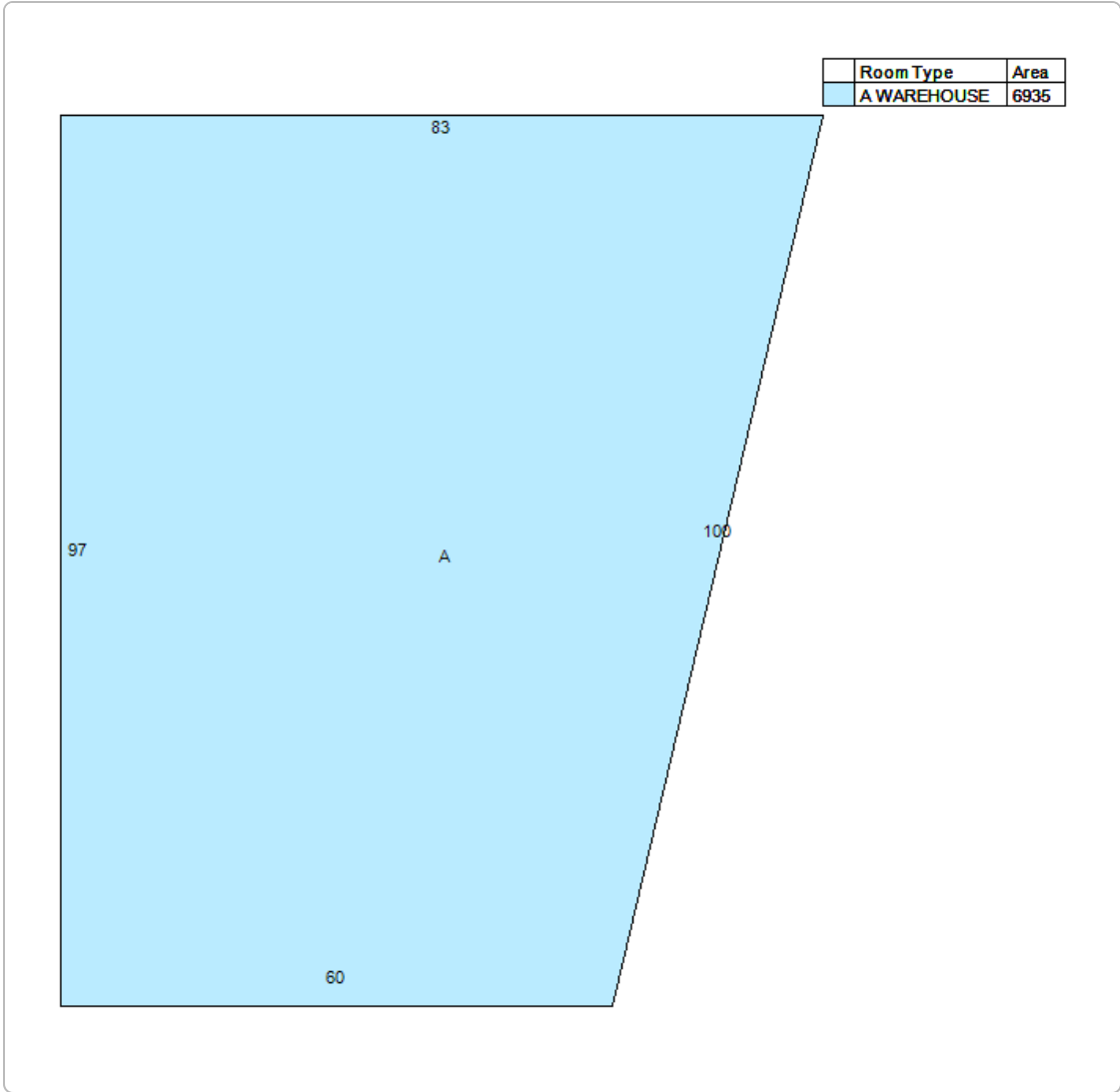

Photos



No data available for the following modules: Assessment Notice, Residential Improvement Information, Comparable Sales List, .

The Fayette County Property Valuation Administrator's Office makes every effort to produce the most accurate information possible. No warranties, expressed or implied, are provided for the data herein, its use or interpretation.
 | [User Privacy Policy](#) | [GDPR Privacy Notice](#)
 Last Data Upload: 4/9/2024, 5:38:14 AM

Contact Us

