

Summary

Parcel Number 38089140
 Location Address 1792 ALYSHEBA WAY
 LEXINGTON KY 40509
 Tax District District 01
 Tax Rate 1.2846
 Acres 5.45
 Legal Description L-784 HAMBURG PL FARM HAMBURG PL OFF PARK LOT 1
 Property Class C - COMMERCIAL
 PVA Neighborhood 725 - HAMBURG
 Land Use Code (420) C-OFFICE
 USA/RSA Map 43
 Map Block 001
 Lot 1
 Subdivision HAMBURG PL FARM HAMBURG PL OFF PARK
 Cabinet/Slide L-784
 ND-1 Zone
 Overlay
 PDR
 Map Scale 200
 Block
 LFUCG Zoning P-1 - PROFESSIONAL OFFICE
 Deeded SqFt 237,402
 Frontage / Out of 465.7 /



Owner

MADDEN FAMILY LLC NO 20
 PO BOX 12128
 LEXINGTON KY 40580
 January 1, 2023 Owner
 MADDEN FAMILY LLC NO 20

Commercial Improvement Information

Card	1	Year Built	2003
Building No	1	Above Grade Sqft	75,420
Structure Code/Desc	353-OFFICE BLDG	Total Basement Sqft	
Units	0		

Sales

Sale Date	Sale Price	Deed Book	Deed Page	Sales Validity	Owner	Previous Owner	Recording
10/14/2002	\$0	2321	586	TRANSFER-TAX NOT PAID	MADDEN FAMILY LLC NO 20	MADDEN MADDEN ET AL	2321 586
12/17/1980	\$0	1445	123	NEW ACCOUNT	MADDEN MADDEN ET AL		1445 123
12/17/1980	\$0	1266	255	NEW ACCOUNT	MADDEN MADDEN ET AL		1266 255

Valuation

	2022	2021	2020	2019
Fair Cash Value	\$8,370,000	\$8,370,000	\$8,370,000	\$8,370,000
Agricultural Value Land	\$0	\$0	\$0	\$0
Agricultural Value Total	\$0	\$0	\$0	\$0
Exempt	\$0	\$0	\$0	\$0
Taxable Value	\$8,370,000	\$8,370,000	\$8,370,000	\$8,370,000

Sketches

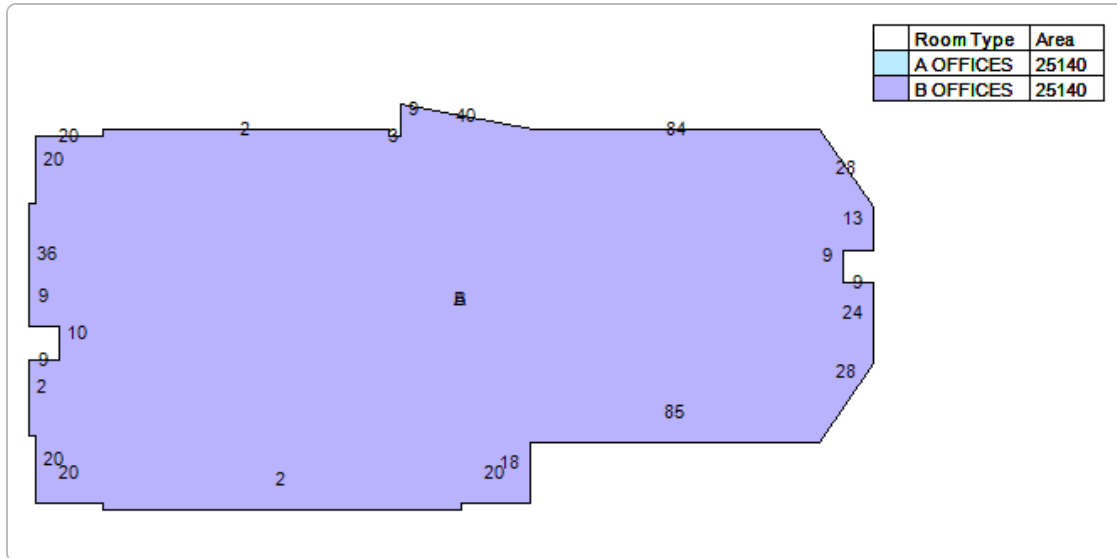

Photos



No data available for the following modules: Assessment Notice, Residential Improvement Information, Accessory Information, Comparable Sales List, .

The Fayette County Property Valuation Administrator's Office makes every effort to produce the most accurate information possible. No warranties, expressed or implied, are provided for the data herein, its use or interpretation.

[User Privacy Policy](#)
[GDPR Privacy Notice](#)

[Last Data Upload: 4/7/2023, 9:36:16 PM](#)

Developed by
 Schneider
 GEOSPATIAL

Version 2.3.255