

Summary

Parcel Number 19302210
 Location Address 3061 FIELDSTONE WAY
 LEXINGTON KY 40513
 Tax District District 01
 Tax Rate 1.2777
 Acres 2.26
 Legal Description L-184 LOT
 Property Class C - COMMERCIAL
 PVA Neighborhood 715 - HARRODSBURG
 Land Use Code (430) C-RETAIL
 USA/RSA Map 38
 Map Block 001
 Lot
 Subdivision
 Cabinet/Slide L-184
 ND-1 Zone
 Overlay
 PDR
 Map Scale 200
 Block A
 LFUCG Zoning B-3 - HIGHWAY SERVICE BUSINESS
 Deeded SqFt 98,446
 Frontage / Out of 0/



Owner

BEAUMONT SHOPPES LLC
 C/O SCHRADER COMMERCIAL PROPERTIES
 PO BOX 21793
 LEXINGTON KY 40522
 January 1, 2021 Owner
 BEAUMONT SHOPPES LLC
 C/O SCHRADER COMMERCIAL PROPERTIES

Commercial Improvement Information

Card 1
 Building No 1
 Structure Code/Desc 343-NBHD SHP CTR
 Units 0
 Year Built 1996
 Above Grade Sqft 24,420
 Total Basement Sqft

Sales

Sale Date	Sale Price	Deed Book	Deed Page	Sales Validity	Owner	Previous Owner	Recording
4/12/1996	\$0	1841	250	OTHER	BEAUMONT SHOPPES LLC	BEAUMONT INVESTMENTS LLC	1841 250
9/2/1994	\$0	0043	215	ARMS LENGTH TRANSACTION	BEAUMONT INVESTMENTS	BANK ONE LEXINGTON NA	0043 215

Valuation

	2020	2019	2018	2017
Fair Cash Value	\$3,251,500	\$3,251,500	\$3,174,600	\$3,174,600
Agricultural Value Land	\$0	\$0	\$0	\$0
Agricultural Value Total	\$0	\$0	\$0	\$0
Exempt	\$0	\$0	\$0	\$0
Taxable Value	\$3,251,500	\$3,251,500	\$3,174,600	\$3,174,600

Sketches

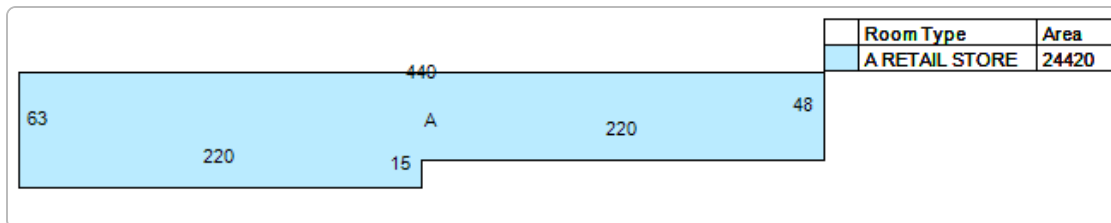

Photos



No data available for the following modules: Residential Improvement Information, Accessory Information, Comparable Sales List, .

The Fayette County Property Valuation Administrator's Office makes every effort to produce the most accurate information possible. No warranties, expressed or implied, are provided for the data herein, its use or interpretation.

[User Privacy Policy](#)
[GDPR Privacy Notice](#)

[Last Data Upload: 1/15/2021, 3:23:31 AM](#)

[Version 2.3.102](#)

Developed by
 Schneider
GEOSPATIAL